

## How to fit and tension

### FACE FIXED BANTAM SPRING ROLLER BLIND

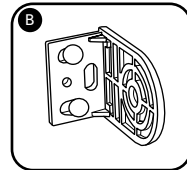
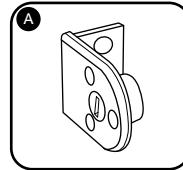
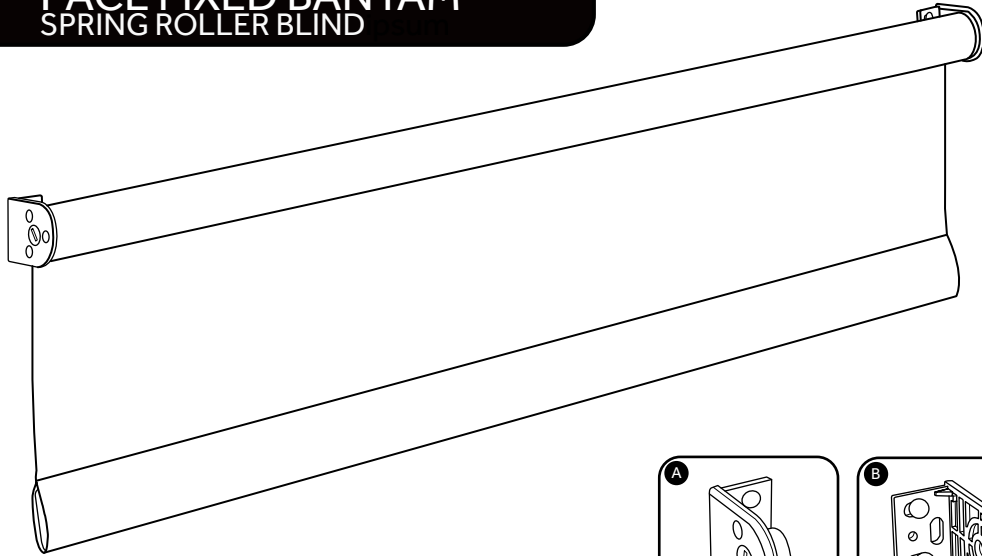

**1**

Face fix plastic brackets(A,B) onto the frame in desired position. For reversed roll blind fit the brackets opposite way around.

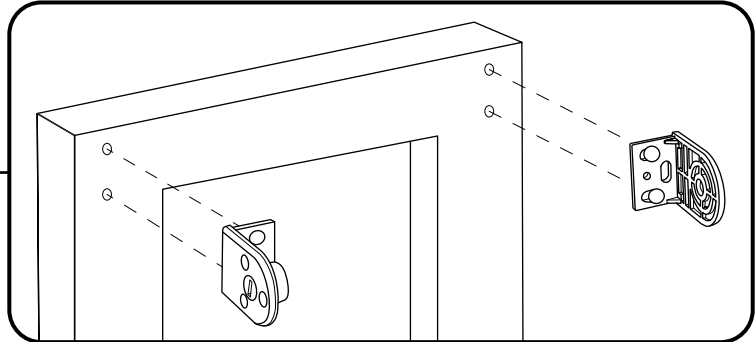

**2**

Insert idle end into the bracket.

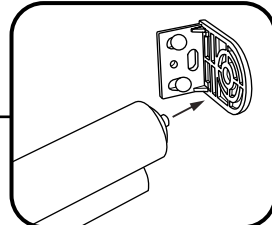

**3**

Insert spring end into the bracket.

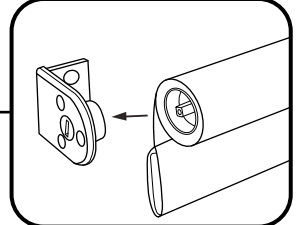

**4**

Tension the spring by applying 6 turns in clockwise fashion. For reversed roll, turns should be applied anti-clockwise.

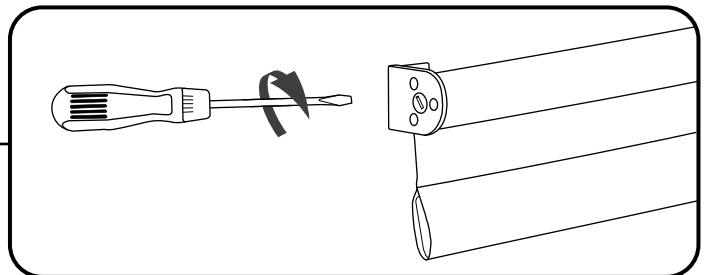

**5**

Test the blind. It should roll back up itself. If doesn't, go back to step 4 and apply additional turns.

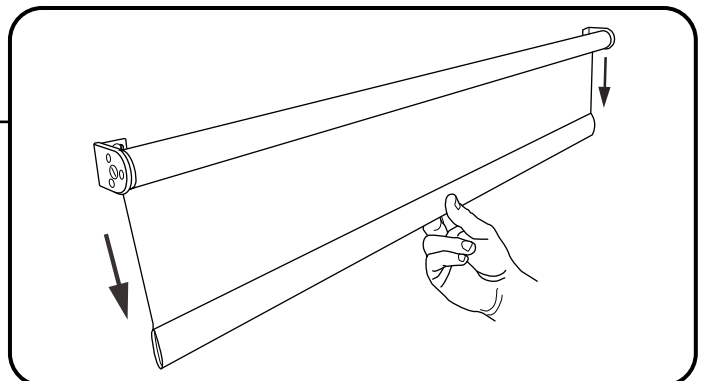

Visit our YouTube channel and watch the How to video here.

[https://youtu.be/qhw\\_svhXZpl](https://youtu.be/qhw_svhXZpl)

