

# ROLLER 45 MAINS/RJ12 MOTOR 191633

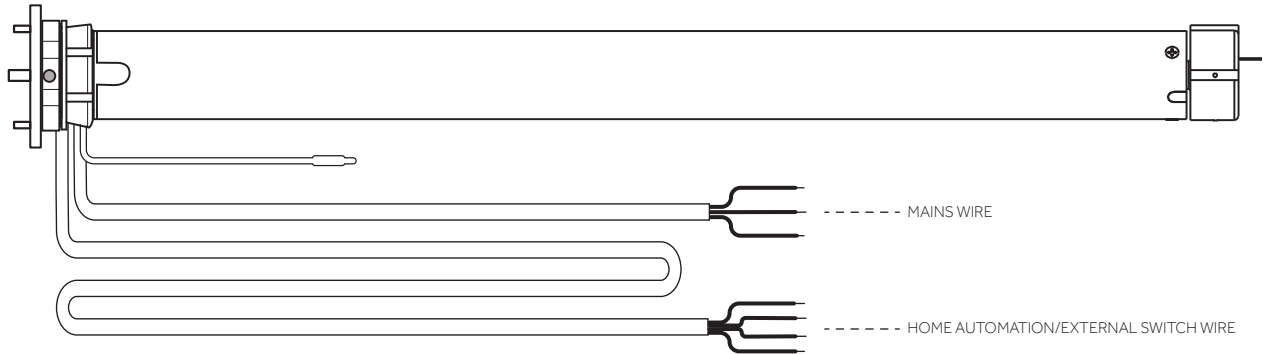

## TECHNICAL SPECIFICATION

CONTROL TYPE	RADIO	RATED VOLTAGE	230 V	IP RATING	IP44
LIMITS	ELECTRONIC (set remotely)	RATED POWER	121 W	LIFTING CAPACITY	26.7 Kg
OUTPUT SPEED	28 rpm	RATED CURRENT	0.53 A	MIN. BLIND WIDTH	640 mm
RATED TORQUE	6 N.m	RADIO FREQUENCY	433.92 MHz	MOTOR LENGTH	580 mm

## FUNCTIONAL FEATURES

- Bi-Directional Functionality
- Electronic Limit Setting
- Jog Mode
- Program / Operation Button (P1)
- Internally Stored Settings
- Pair with up to 10 Control Devices
- Switch Direction
- Built-in Radio Receiver
- Favourite Stop Position

## WIRING

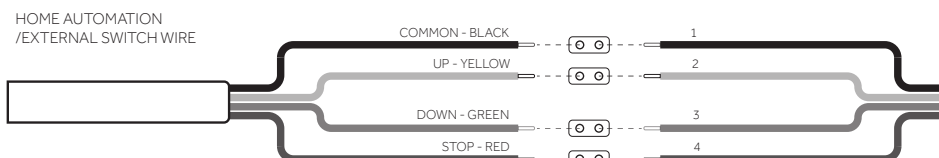
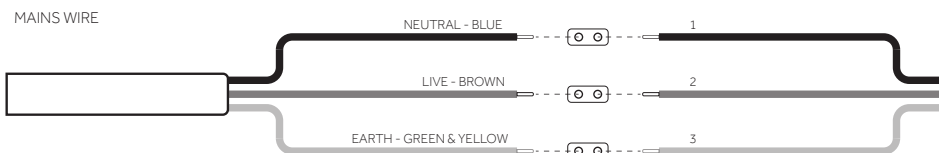

# PROGRAMMING INSTRUCTIONS

## BUTTON SPECIFICATION

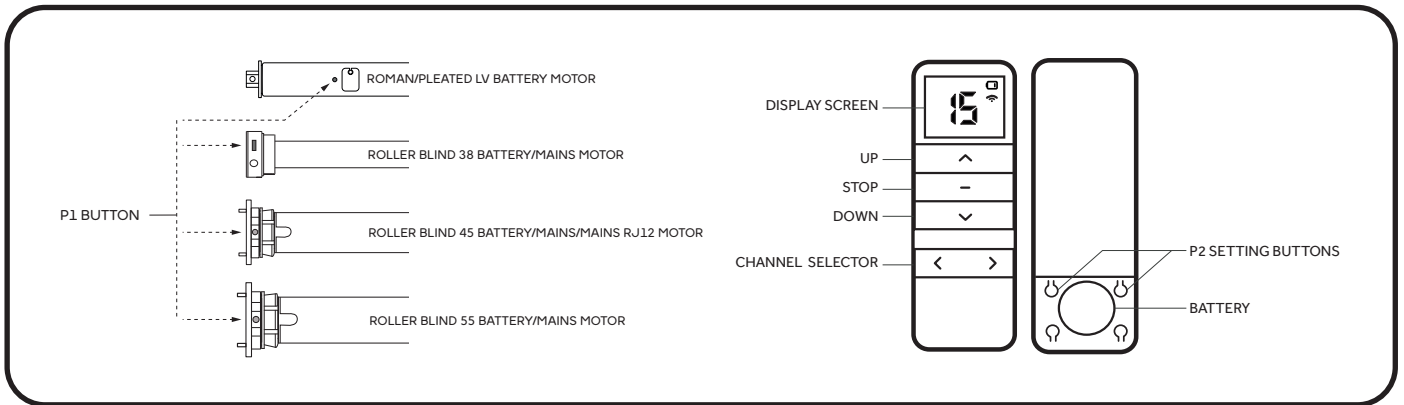

## 1. P1 BUTTON SETTINGS

### SHORT PRESS FUNCTION

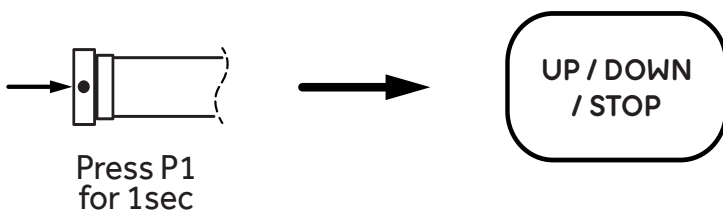

**Note:**  
When in jog-mode, holding the up or down buttons will temporarily provide continuous-moving.

### SLEEP MODE

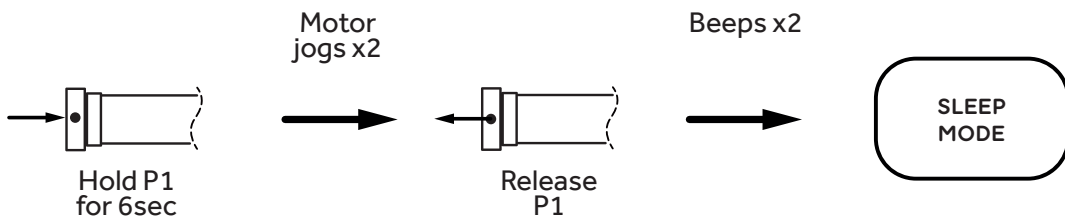

**Note:**  
Sleep mode can be utilised to temporarily deactivate a motor's radio functionality, allowing for multiple motors to be added to a shared channel without disruption. Press P1 to restore functionality.

## SWITCHING DIRECTION

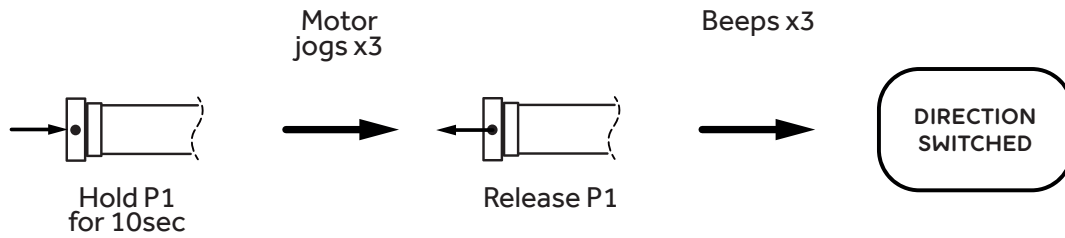

**Note:**

Switching direction using the P1 button is only available once a remote has been paired with the motor.

## RESTORING FACTORY SETTINGS

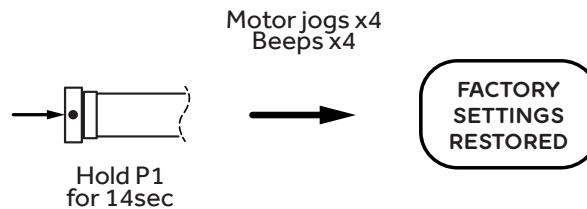

## WATCH THE VIDEO

DREAM RANGE PROGRAMMING INSTRUCTIONS  
- OVERVIEW AND P1 FUNCTIONALITY

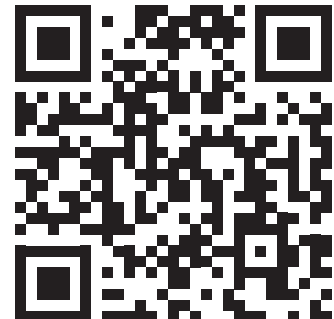

## 2. PAIRING A REMOTE AND INITIAL SETTINGS

### PAIRING A REMOTE WITH A MOTOR

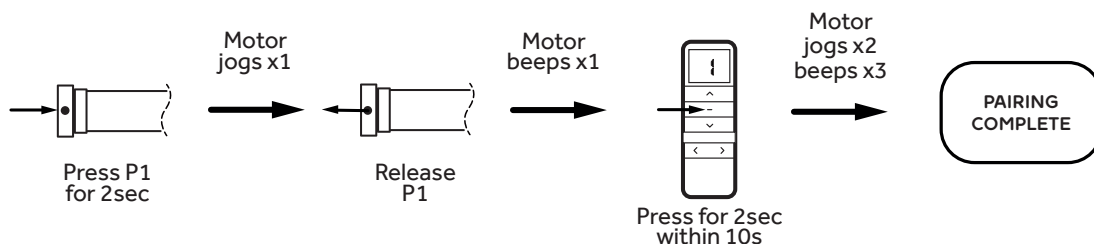

**Note:**

After pairing a remote and before setting limits, the motor will be defaulted to jog-mode. To switch to continuous-mode, see **ADVANCED FUNCTIONALITY - SWITCHING BETWEEN JOG MODE AND CONTINUOUS MODE** on page 15.

## SWITCHING DIRECTION

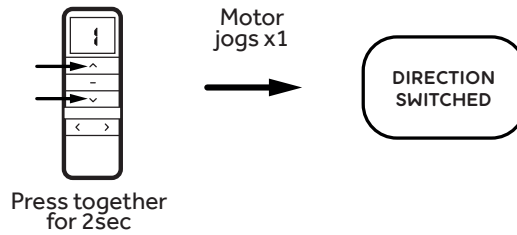

**Note:**

Switching direction with a remote device is only possible before setting top and bottom limits. To switch after limits have been set, see P1 BUTTON SETTINGS - SWITCHING DIRECTION on page 14.

## SETTING THE TOP LIMIT

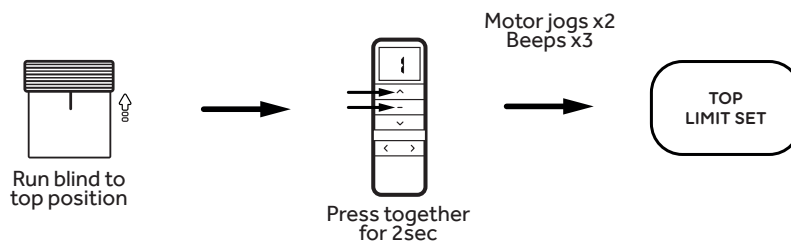

## SETTING THE BOTTOM LIMIT

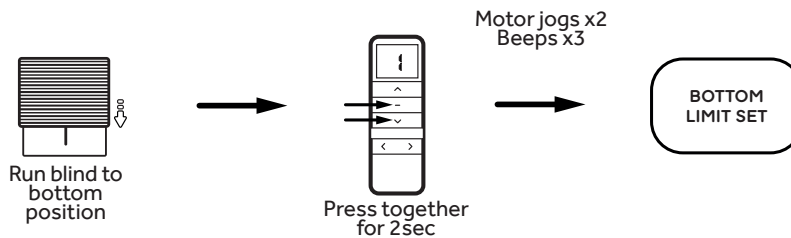

**Note:**

After setting top and bottom limits, the motor will automatically switch to continuous mode. To switch to jog mode, see ADVANCED FUNCTIONALITY - SWITCHING BETWEEN JOG MODE AND CONTINUOUS MODE on page 15.

## WATCH THE VIDEO

DREAM RANGE PROGRAMMING INSTRUCTIONS  
- PAIRING A REMOTE AND INITIAL SETTINGS

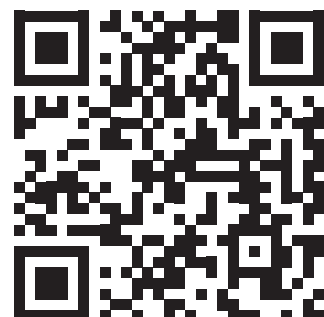

### 3. ADVANCED SETTINGS

#### SWITCHING FROM CONTINUOUS MODE TO JOG MODE

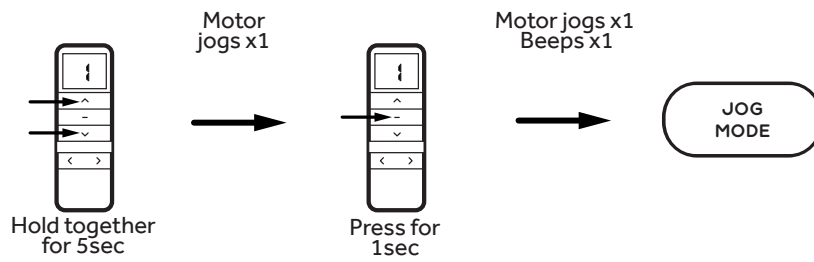

**Note:**

When in jog mode, holding the up or down buttons will provide continuous-moving temporarily.

#### SWITCHING FROM JOG MODE TO CONTINUOUS MODE

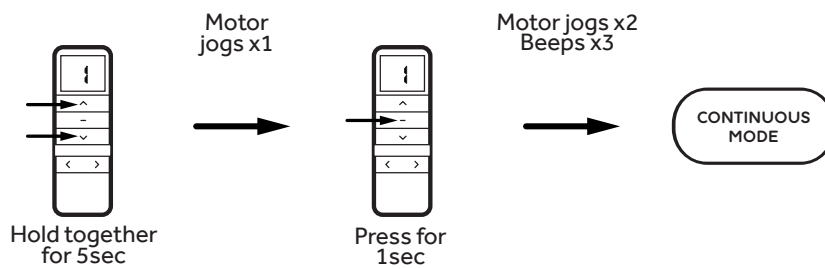

**Note:**

When in jog mode, holding the up or down buttons will provide continuous-moving temporarily.

#### INCREASING MOTOR SPEED

BATTERY MOTORS ONLY

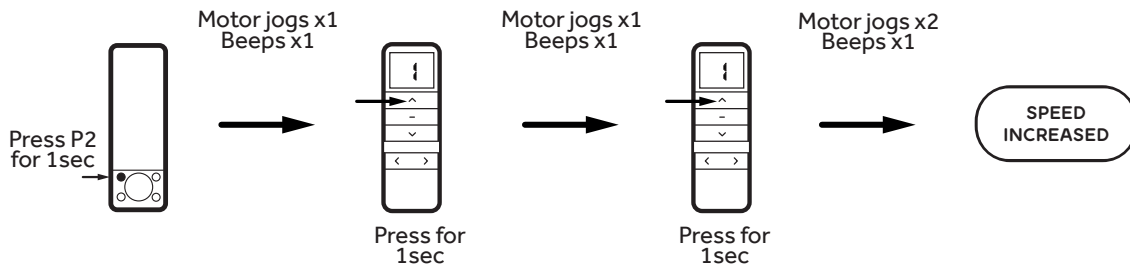

**Note:**

If the motor does not respond to these instructions, it has already reached its upper speed setting.

#### DECREASING MOTOR SPEED

BATTERY MOTORS ONLY

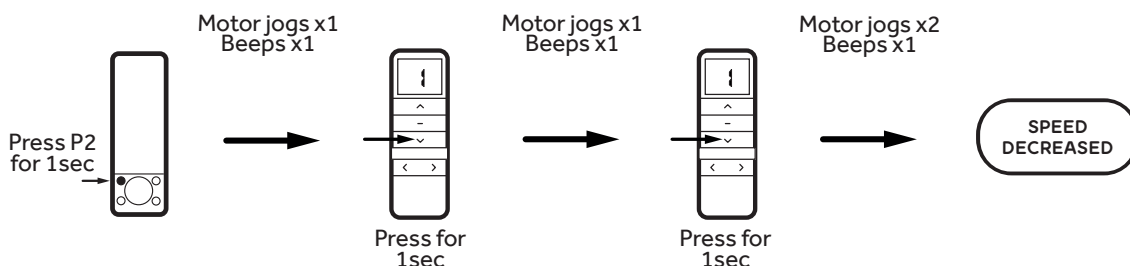

**Note:**

If the motor does not respond to these instructions, it has already reached its upper speed setting.

## DECREASING MOTOR SPEED

BATTERY MOTORS ONLY

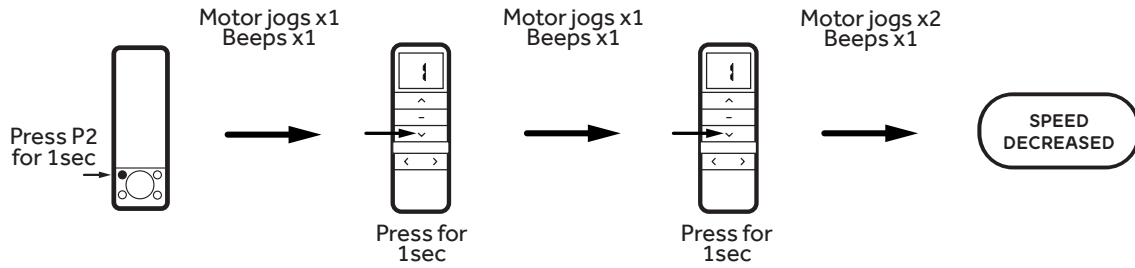

### Note:

If the motor does not respond to these instructions, it has already reached its upper speed setting.

## CLEARING A FAVOURITE STOP POSITION

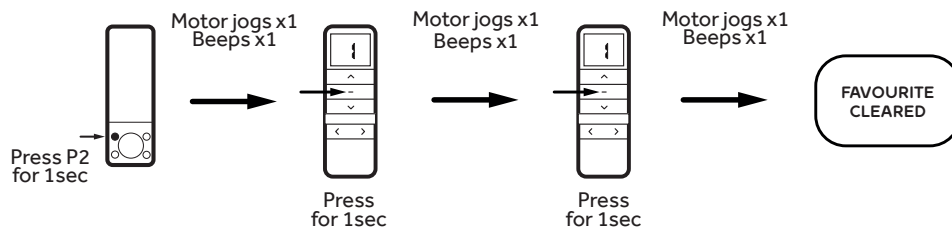

## FINE-TUNING A TOP LIMIT

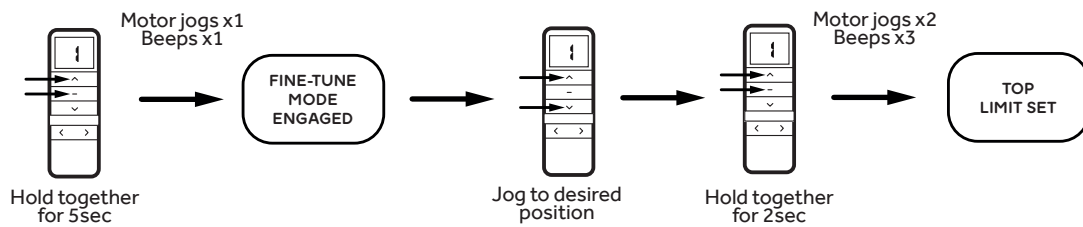

## FINE-TUNING A BOTTOM LIMIT

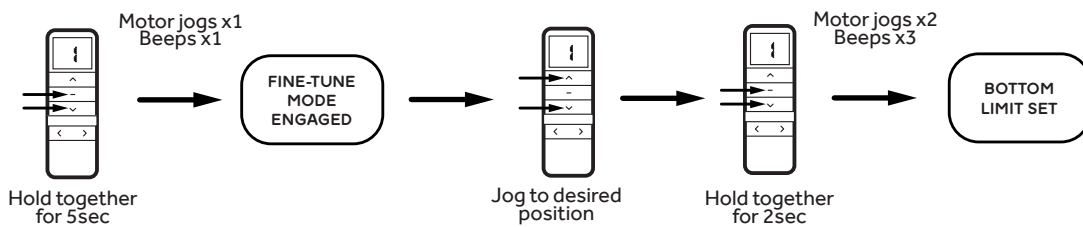

## ADDING/REMOVING AN EXTRA REMOTE

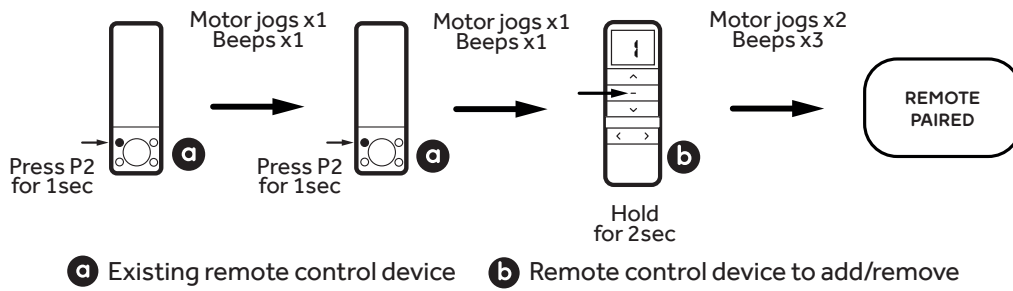

## WATCH THE VIDEO

DREAM RANGE PROGRAMMING INSTRUCTIONS  
- ADVANCED FUNCTIONALITY



Damaged/unused electrical products and batteries are not be disposed with regular household waste. Dispose of this device in compliance with your authorities waste regulations. Alternatively, return your motors to Decorquip Ltd.



**Decorquip Ltd**

Rhymney House, Unit 8, Bedwas House Industrial Estate, Bedwas, Caerphilly, CF83 8DW. T: 029 2088 0811