

# ROLLER 55 MAINS MOTOR 191712

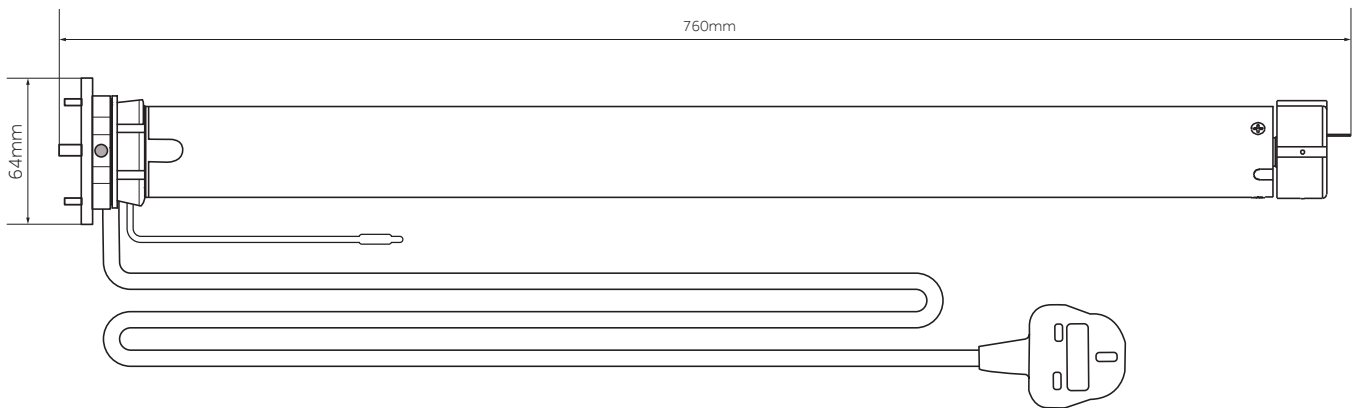

## TECHNICAL SPECIFICATION

<b>CONTROL TYPE</b>	RADIO	<b>RATED VOLTAGE</b>	230 V	<b>IP RATING</b>	IP44
<b>LIMITS</b>	ELECTRONIC (set remotely)	<b>RATED POWER</b>	155 W	<b>LIFTING CAPACITY</b>	21.8 Kg
<b>OUTPUT SPEED</b>	28 rmp	<b>RATED CURRENT</b>	0.63 A	<b>MIN. BLIND WIDTH</b>	830 mm
<b>RATED TORQUE</b>	6 N.m	<b>RADIO FREQUENCY</b>	433.92 MHz	<b>MOTOR LENGTH</b>	780 mm

## FUNCTIONAL FEATURES

- Bi-Directional Functionality
- Electronic Limit Setting
- Jog Mode
- Program / Operation Button (P1)
- Three Speed Settings (battery motors)
- Built-in Lithium-ion Battery (battery motors)
- Mains / Solar Charging (battery motors)
- Switch Direction
- Built-in Radio Receiver
- Favourite Stop Position
- Internally Stored Settings
- Pair with up to 10 Control Devices

# PROGRAMMING INSTRUCTIONS

## BUTTON SPECIFICATION

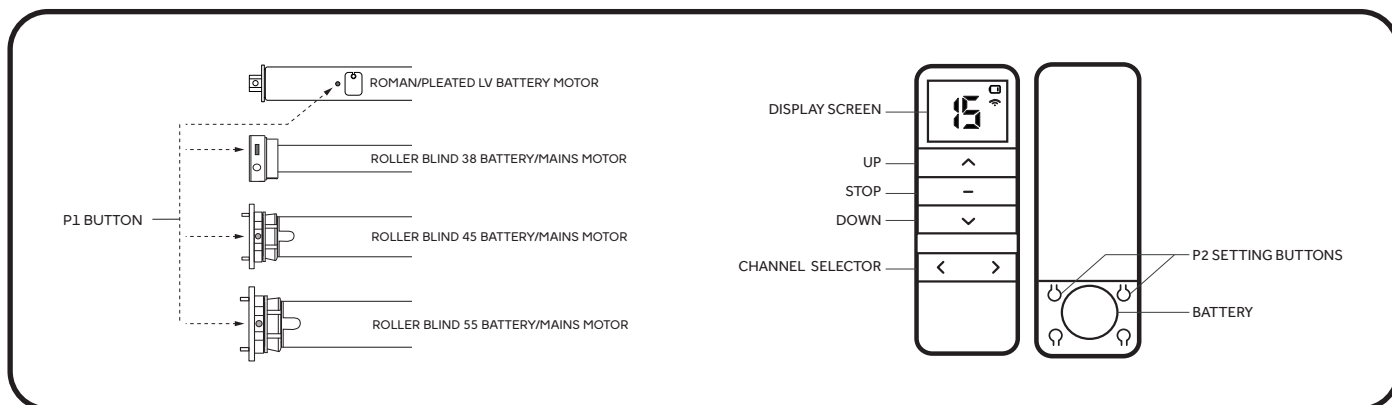

## 1. P1 BUTTON SETTINGS

### SHORT PRESS FUNCTION

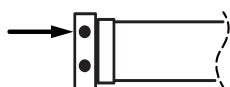

Press P1  
for 1sec



#### Note:

When in jog-mode, holding the up or down buttons will temporarily provide continuous-moving.

### SLEEP MODE



Hold P1  
for 6sec

Motor  
jogs x2



Release  
P1

Beeps x2



#### Note:

Sleep mode can be utilised to temporarily deactivate a motor's radio functionality, allowing for multiple motors to be added to a shared channel without disruption. Press P1 to restore functionality.

## SWITCHING DIRECTION

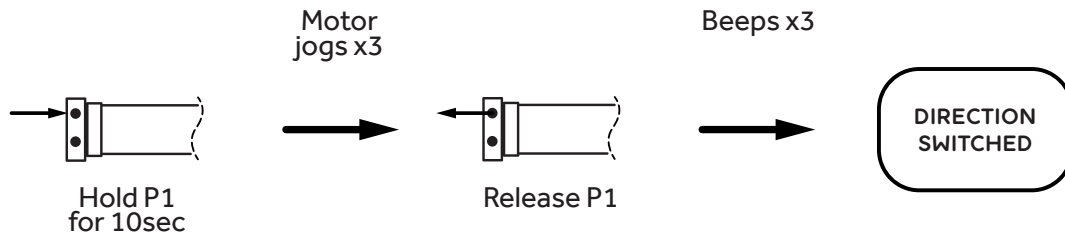

**Note:**

Switching direction using the P1 button is only available once a remote has been paired with the motor.

## RESTORING FACTORY SETTINGS

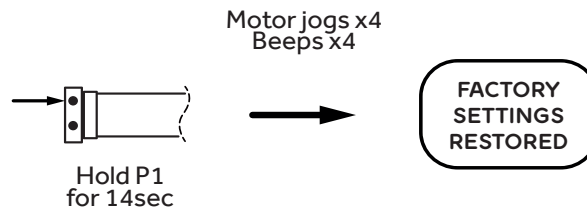

## WATCH THE VIDEO

DREAM RANGE PROGRAMMING INSTRUCTIONS  
- OVERVIEW AND P1 FUNCTIONALITY

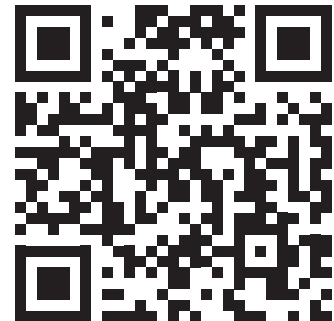

## 2. PAIRING A REMOTE AND INITIAL SETTINGS

### PAIRING A REMOTE WITH A MOTOR

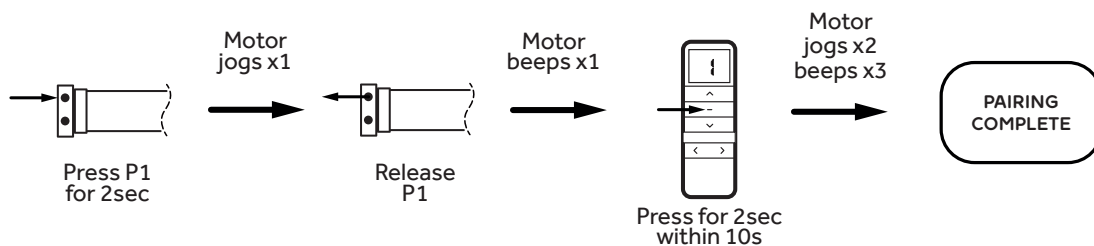

**Note:**

After pairing a remote and before setting limits, the motor will be defaulted to jog-mode. To switch to continuous-mode, see **ADVANCED FUNCTIONALITY - SWITCHING BETWEEN JOG MODE AND CONTINUOUS MODE** on page 15.

## SWITCHING DIRECTION

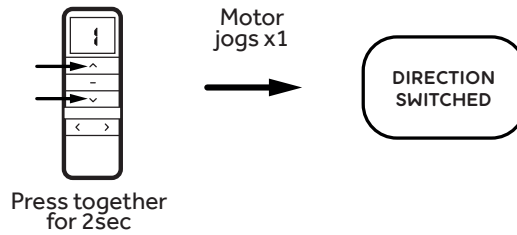

**Note:**

Switching direction with a remote device is only possible before setting top and bottom limits. To switch after limits have been set, see P1 BUTTON SETTINGS - SWITCHING DIRECTION on page 14.

## SETTING THE TOP LIMIT

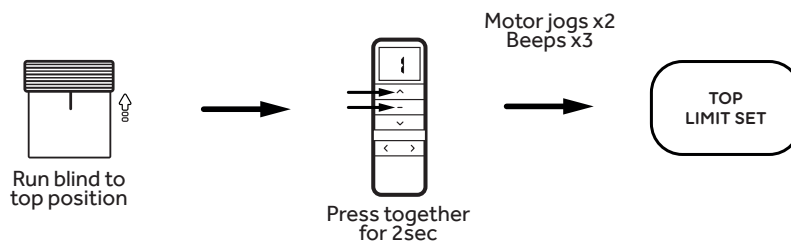

## SETTING THE BOTTOM LIMIT

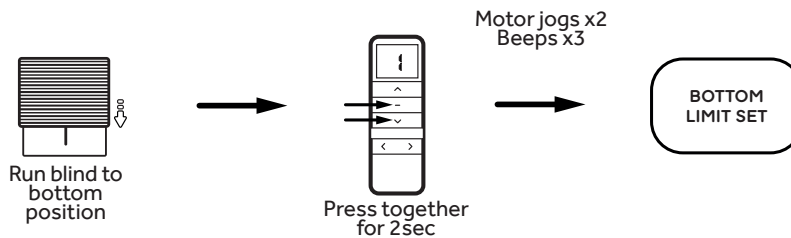

**Note:**

After setting top and bottom limits, the motor will automatically switch to continuous mode. To switch to jog mode, see ADVANCED FUNCTIONALITY - SWITCHING BETWEEN JOG MODE AND CONTINUOUS MODE on page 15.

## WATCH THE VIDEO

DREAM RANGE PROGRAMMING INSTRUCTIONS  
- PAIRING A REMOTE AND INITIAL SETTINGS

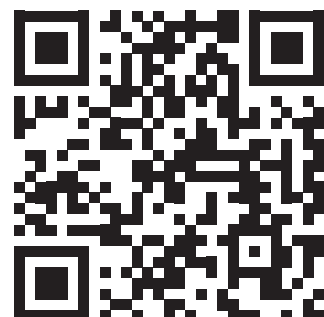

### 3. ADVANCED SETTINGS

#### SWITCHING FROM CONTINUOUS MODE TO JOG MODE

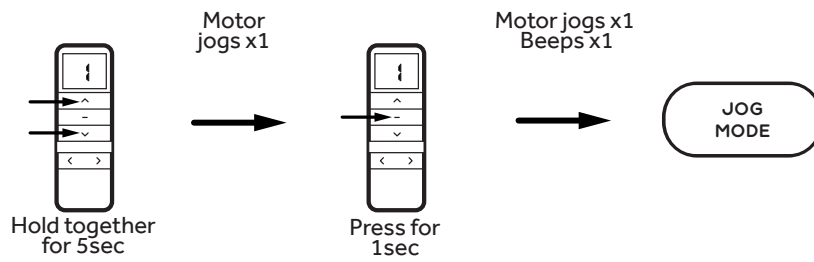

**Note:**

When in jog mode, holding the up or down buttons will provide continuous-moving temporarily.

#### SWITCHING FROM JOG MODE TO CONTINUOUS MODE

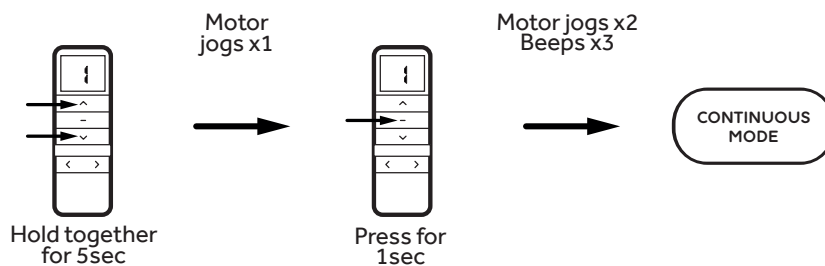

**Note:**

When in jog mode, holding the up or down buttons will provide continuous-moving temporarily.

#### INCREASING MOTOR SPEED

BATTERY MOTORS ONLY

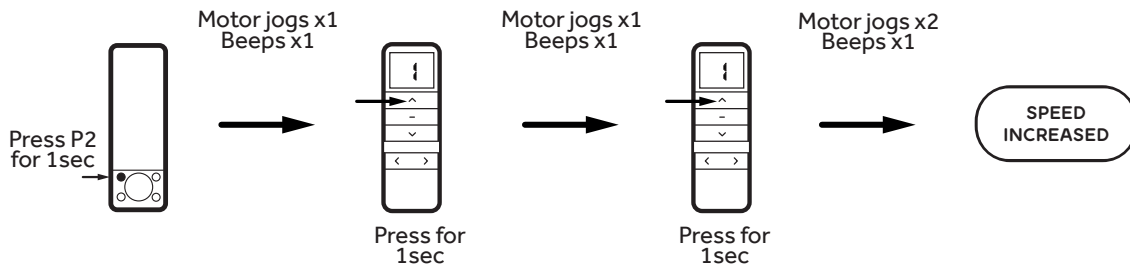

**Note:**

If the motor does not respond to these instructions, it has already reached its upper speed setting.

#### DECREASING MOTOR SPEED

BATTERY MOTORS ONLY

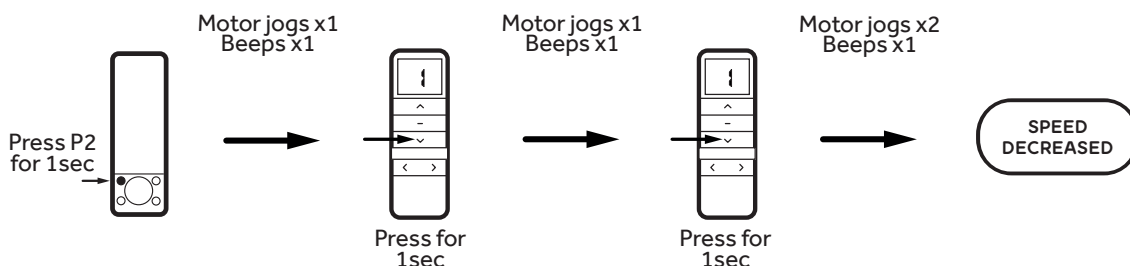

**Note:**

If the motor does not respond to these instructions, it has already reached its upper speed setting.

## DECREASING MOTOR SPEED

BATTERY MOTORS ONLY

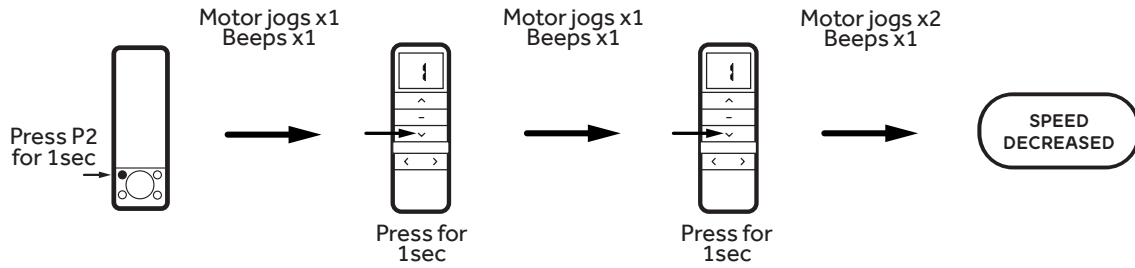

### Note:

If the motor does not respond to these instructions, it has already reached its upper speed setting.

## CLEARING A FAVOURITE STOP POSITION

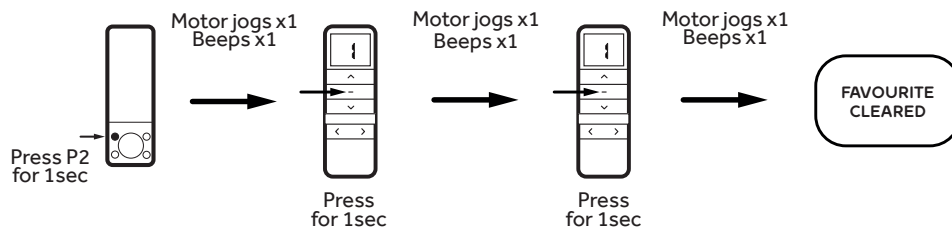

## FINE-TUNING A TOP LIMIT

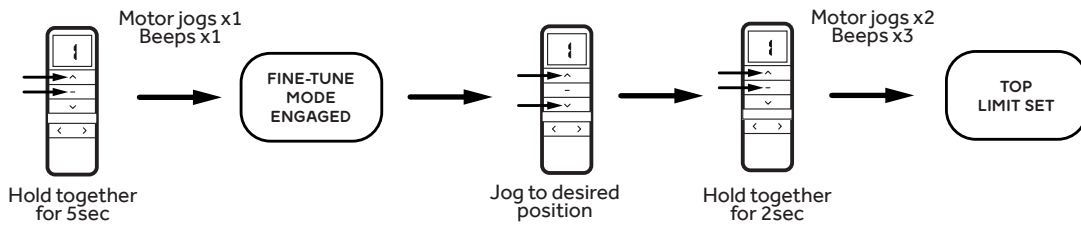

## FINE-TUNING A BOTTOM LIMIT

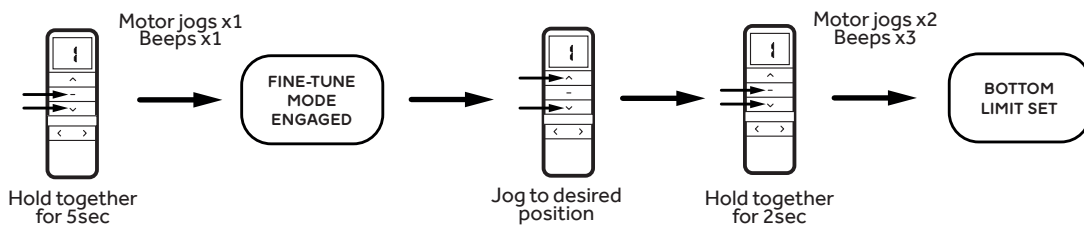

## ADDING/REMOVING AN EXTRA REMOTE

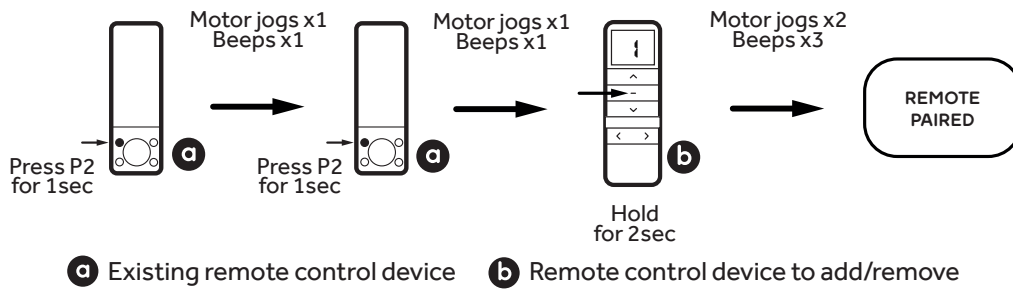

## WATCH THE VIDEO

DREAM RANGE PROGRAMMING INSTRUCTIONS  
- ADVANCED FUNCTIONALITY



Get instant access to all information you'll ever need about our Dream Range motorisation and become an expert in minutes.

The Dream Range User's Guide is available for everyone to download and we encourage you to share it with your clients. Just scan the QR code, download or print the guide.



From basic product information and functionality to more advanced setup, our easy to follow and quick to complete step-by-step guide gives you or your clients an instant solution - no matter where you are.

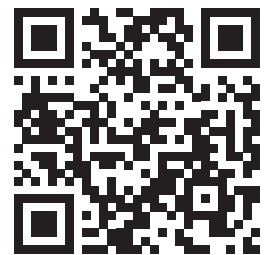

Find out more about the Dream Range products - from battery motors and controls to smart home automation options, whatever bespoke solution you're looking to create - we've got you covered.

