

# DECORQUIP®

## Senses & Double Roller Blinds

Warning - the operating instructions must be read before operating the blind.

### Fitting Instructions

This procedure can be completed by non-professionals.

1. Check which brackets have been supplied - top fix or face fix.

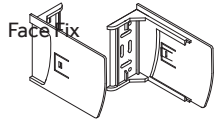

#### 2. Face Fix Brackets Fitting Instructions (please note that it is not recommended to use face fix brackets in a recess).

2.1. Position the brackets outside the recess at the edges of the fascia (see the exploded diagram on the opposite side of these instructions).

2.2. If necessary, center support brackets would be supplied. Space these out equally across with width of the blind. Position the brackets so the screw holes are at the same height as the holes for the side brackets.

2.3. If necessary, mark through the brackets with a pencil, and drill and plug holes for the screws.

2.4. Fix the brackets with suitable fixings (please note that screws and other fixings are not provided).

2.5. Line the fascia end caps with the brackets and slide the blind into the brackets. The blind should click into place.

2.6. If applicable, fix the fixed tensioning safety device according to the instructions below. Use the drawings to identify which device has been supplied.

2.7. Remove the strip of fabric wrapped around the blind and you should be able to operate the blind normally.

2.8. To remove the blind from the brackets, use a flat head screw driver to lever the side of the bracket away from the fascia to release the blind. Repeat this process with the other bracket and pull the blind out of the brackets.

#### Top Fix Brackets



#### 3. Top Fix Fitting Instructions

3.1. Position the brackets equally across the width of the blind and mark through the holes in the bracket with a pencil, and drill and plug holes for the screws.

3.2. Fix the brackets with suitable fixings (please note that screws and other fixings are not provided), and move to section 4 of these instructions.

3.3. Line the lip on the back of the fascia up with the opening at the front of the top clips and push the blind into the brackets.

3.4. If applicable, fix the fixed tensioning safety device according to the instructions below. Use the drawings to identify which device has been supplied.

3.5. Remove the strip of fabric wrapped around the blind and you should be able to operate the blind normally.

3.6. To remove the blind from the brackets, grip the blind and the fascia and rotate the blind downwards to open the brackets. Whilst holding the blind in this position, pull the blind out of the brackets.

### Fitting the Safety Device: PermaHold 400978

1. Once the blind has been fitted, position the PermaHold Device at the maximum distance possible from the control mechanism to prevent the looped pull chain becoming slack and make a mark through the screw holes.

3. Move the device to one side and using the marks made in step 2, drill and plug the holes.

4. Using suitable fixings, fix into position so that the spring in the device is fully compressed and the device is securely mounted. No.6 counter sunk screws are required.

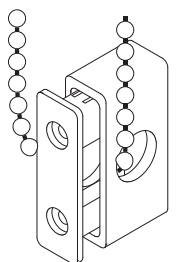

**Children can be strangled if this safety device is not installed.  
Always use this device to keep cords or chains out of reach of children.**

### Fitting the Safety Device: 'P' Clip 400990

1. Once the blind has been fitted, position the 'P' Clip at the maximum distance possible from the control mechanism to prevent the looped pull chain becoming slack and make a mark through the screw holes.

3. Move the device to one side and using the marks made in step 2, drill and plug the holes.

4. Using suitable fixings, fix into position so that the device is securely mounted.

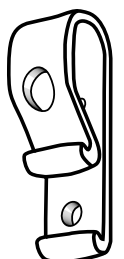

**Children can be strangled if this safety device is not installed.  
Always use this device to keep cords or chains out of reach of children.**

# DECORQUIP®

## Operating Instructions

1. Pull the chain to open or close the blind.
2. Do not lift the blind up further than necessary as pulling the blind up to far can damage the blind.

## Care Instructions

1. Wiping the blind with a soft brush or duster is usually sufficient.
2. If necessary, Blinds can be wiped clean with a mild detergent and warm water. Leave in the open position to dry.
3. Do not make alterations to the blind, chain or safety device.

## Double Roller Blind Exploded Diagram

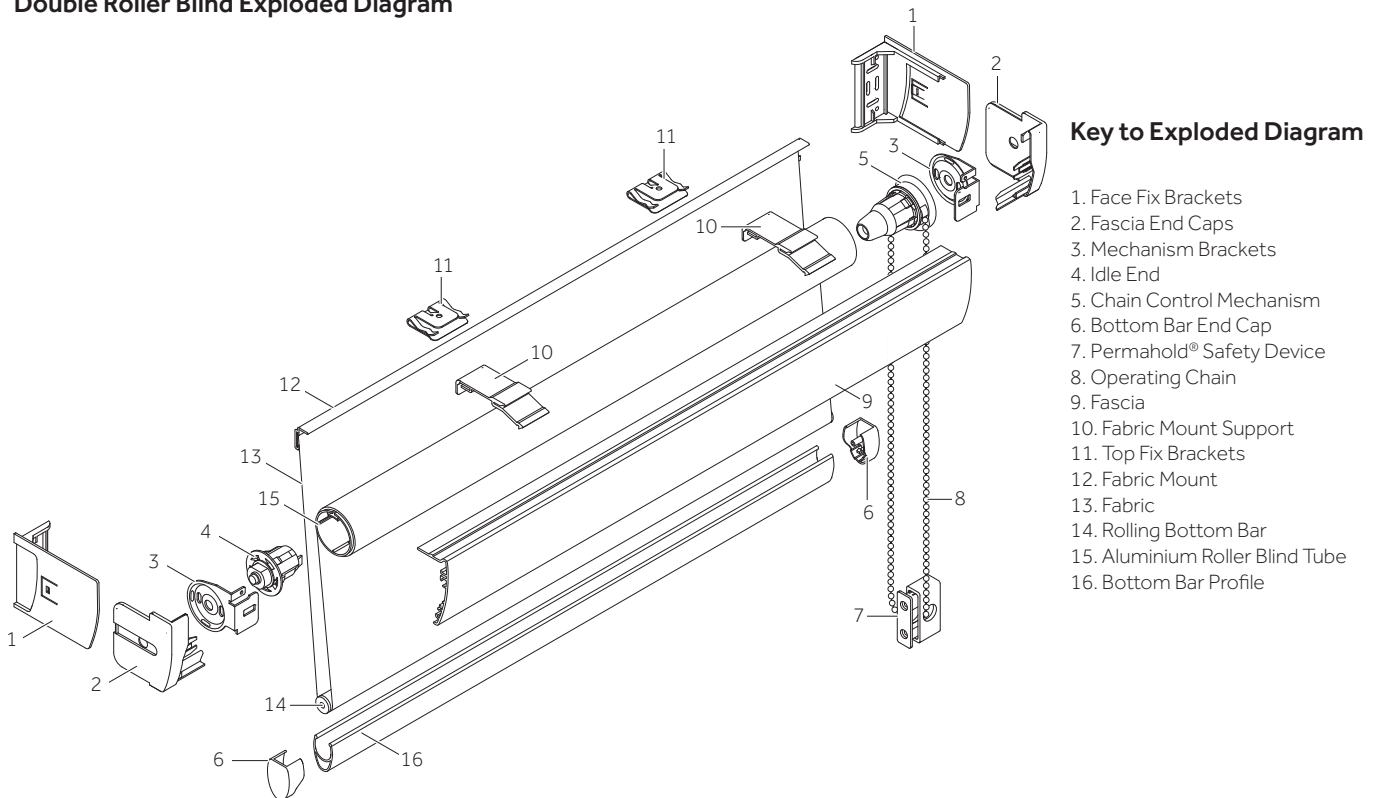

### Key to Exploded Diagram

1. Face Fix Brackets
2. Fascia End Caps
3. Mechanism Brackets
4. Idle End
5. Chain Control Mechanism
6. Bottom Bar End Cap
7. Permahold® Safety Device
8. Operating Chain
9. Fascia
10. Fabric Mount Support
11. Top Fix Brackets
12. Fabric Mount
13. Fabric
14. Rolling Bottom Bar
15. Aluminium Roller Blind Tube
16. Bottom Bar Profile



## WARNING



Young children can be strangled by loops in pull cords, chains, tapes and inner cords that operate the product.

To avoid strangulation and entanglement, keep cords out of the reach of young children. Cords may become wrapped around a child's neck.

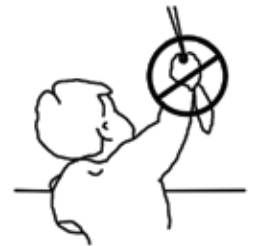

Move beds, cots and furniture away from window covering cords.

Do not tie cords together. Make sure cords do not twist and create a loop.

Always fit the chain and rear cord safety devices.