

XL ROMAN BLIND BATTERY MOTOR 191713

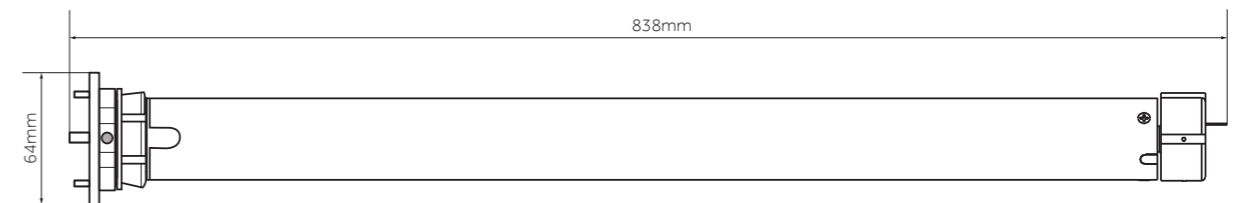

FUNCTIONAL FEATURES

- Bi-Directional Functionality
- Electronic Limit Setting
- Jog Mode
- Program / Operation Button (P1)
- Three Speed Settings
- Cordless Lithium-ion Battery
- Mains / Solar Charging
- Switch Direction
- Built-in Radio Receiver
- Favourite Stop Position
- Internally Stored Settings
- Pair with up to 10 Control Devices

PROGRAMMING

BUTTON SPECIFICATION

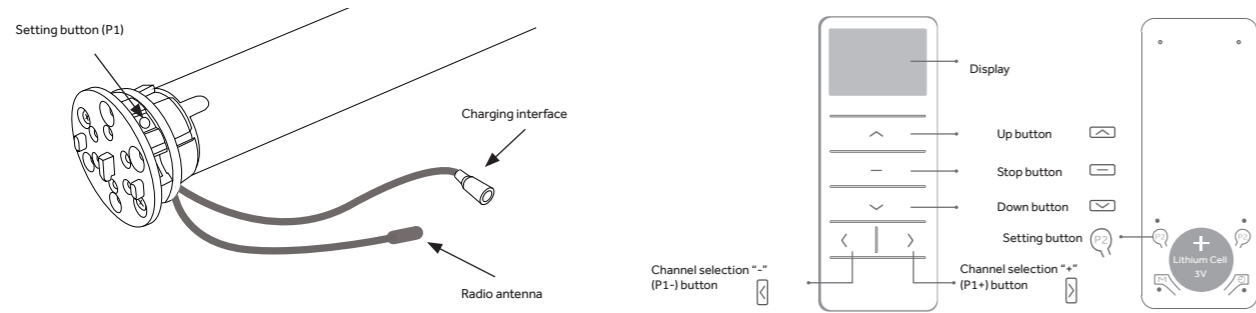

INITIAL FACTORY SET UP

1 PAIRING A REMOTE

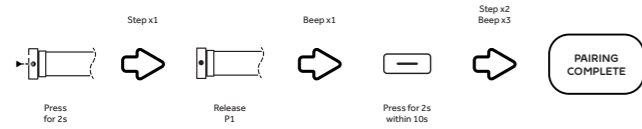

Note: After pairing a remote control device and before setting limits, the motor will be default to jog-mode. To switch to continuous-mode, see REMOTE SETTINGS STEP 1.

3 SETTING TOP LIMIT



2 SWITCHING DIRECTION (OPTIONAL)

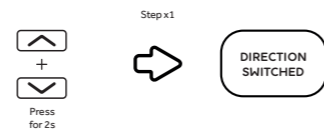

Note: Switching directions with a remote control device is only possible before setting top and bottom limits. To switch after limits have been set, see P1 BUTTON SETTINGS STEP 3.

4 SETTING BOTTOM LIMIT

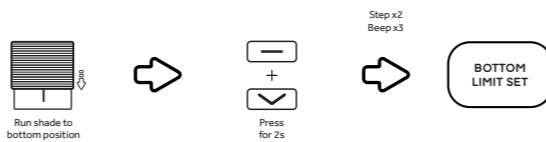

Note: After setting top and bottom limits, the motor will automatically switch to continuous-mode. To switch to jog-mode, see REMOTE SETTINGS STEP 1.

REMOTE SETTINGS

1 JOG-MODE / CONTINUOUS-MODE

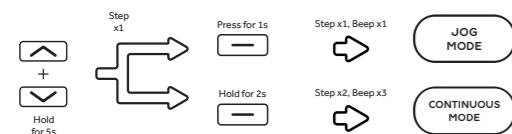

Note: When in jog-mode, holding the up or down buttons will provide continuous-moving temporarily.

2 SETTING SPEEDS



Note: If this process does not result in two steps and a beep, the minimum or maximum speed has been reached.

3 SETTING A FAVOURITE STOP POSITION

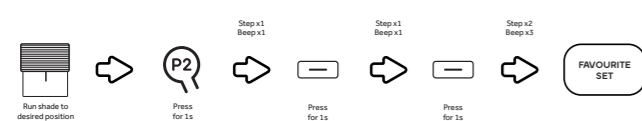

4 CLEARING A FAVOURITE STOP POSITION



5 FINE-TUNING A TOP LIMIT

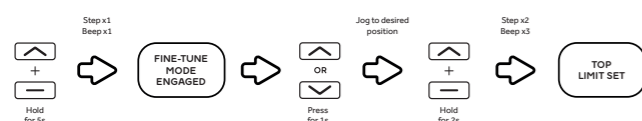

6 FINE-TUNING A BOTTOM LIMIT

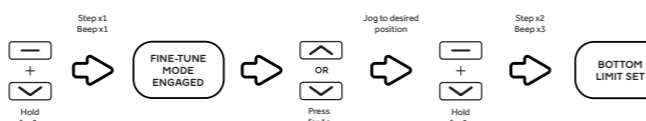

REMOTE SETTINGS (CONTINUED)

7 ADDING/REMOVING AN EXTRA REMOTE

- a existing remote control device
- b remote control device to add/remove

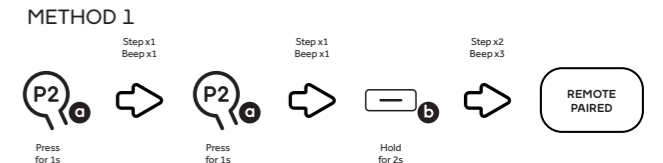

METHOD 2

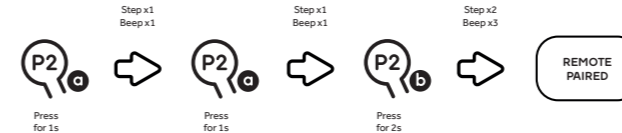

METHOD 3

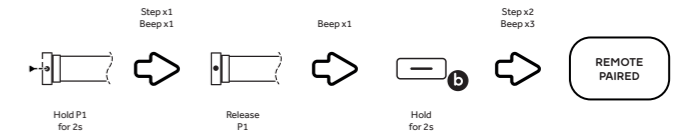

P1 BUTTON SETTINGS

1 SHORT PRESS FUNCTION

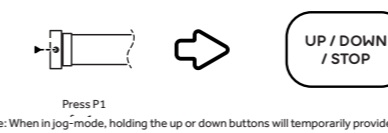

Note: When in jog-mode, holding the up or down buttons will temporarily provide continuous-moving.

2 SLEEP MODE

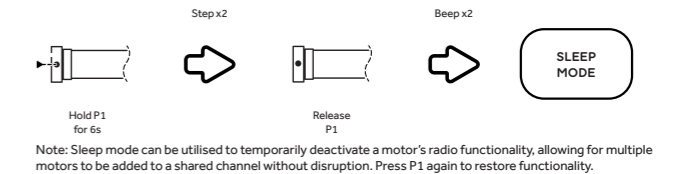

Note: Sleep mode can be utilised to temporarily deactivate a motor's radio functionality, allowing for multiple motors to be added to a shared channel without disruption. Press P1 again to restore functionality.

3 SWITCHING DIRECTION

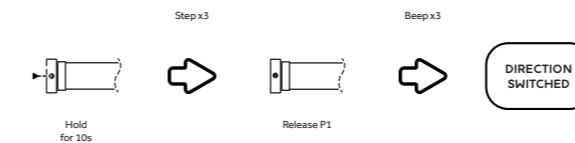

4 RESTORING FACTORY SETTINGS

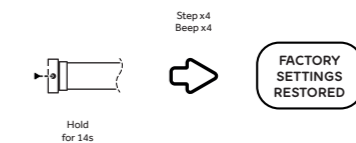

TECHNICAL SPECIFICATION - XL ROMAN BATTERY MOTOR 191713

OUTPUT SPEED	28RPM	RATED CURRENT	1.16A
RATED TORQUE	2N.m	IP PROTECTION RATING	44
RATED VOLTAGE	12v	LIFTING CAPACITY	
RATED POWER	14W	RUNNING NOISE	



Decorquip Ltd. hereby declare that the motor covered by these instructions (XL Roman Battery Motor 191713), is in conformity with the essential requirements of the applicable European Directives and, in particular, the Electromagnetic Compatibility Directive **2014/30/EU**, Machinery Directive **2006/42/EC** and Radio Directive **2014/53/EU**.



Damaged/unused electrical products and batteries are not be disposed with regular household waste. Dispose of this motor in compliance with your authorities waste regulations. Alternatively, return your motors to Decorquip Ltd.

Decorquip Ltd

Rhymney House, Unit 8, Bedwas House Industrial Estate, Bedwas, Caerphilly, CF83 8DW. T: 029 2088 0811