

powered by

eve. | MOTIONBLINDS

ROLLER BLIND SPECIFICATION



DECORQUIP

Smart Roller Blinds powered by Eve MotionBlinds

Eve MotionBlinds support Bluetooth and Thread. Simply scan the HomeKit Setup Code with your iPhone to connect Eve MotionBlinds, and create schedules to put your blinds on autopilot. Instead of relying on a cloud, all data and intelligence are stored locally, which means data exchanged in the home stays in the home.



Min & max sizes

Min. blind width	Max. blind width	Max. blind drop
635mm	2400mm	2500mm



Features



Supported by **Bluetooth** and **Thread**



Super easy setup simply by scanning the HomeKit setup code – **no bridge required**



No registration, no tracking



App and voice control with iPhone, iPad, Apple Watch and HomePod



Just a simple pull automatically sets the blinds in motion, overriding smart controls

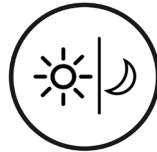

Effortless routine setup that puts the blinds on autopilot, independently of the iPhone and home network

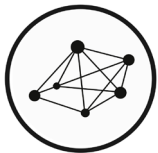

Eve MotionBlinds interact with other HomeKit accessories **creating a smart and safe ecosystem**



Local intelligence and direct **communication without cloud dependency**



Eve MotionBlinds motors will be Matter certified and work directly with all leading smart home systems without a bridge

Requirements



An **iPhone** or **iPad** with the latest version of iOS/iPadOS14



Controlling Eve MotionBlinds automatically and away from home requires a **HomePod** or **Apple TV** (4th generation or later) as a home hub

Eve MotionBlinds - Roller 38 Motor

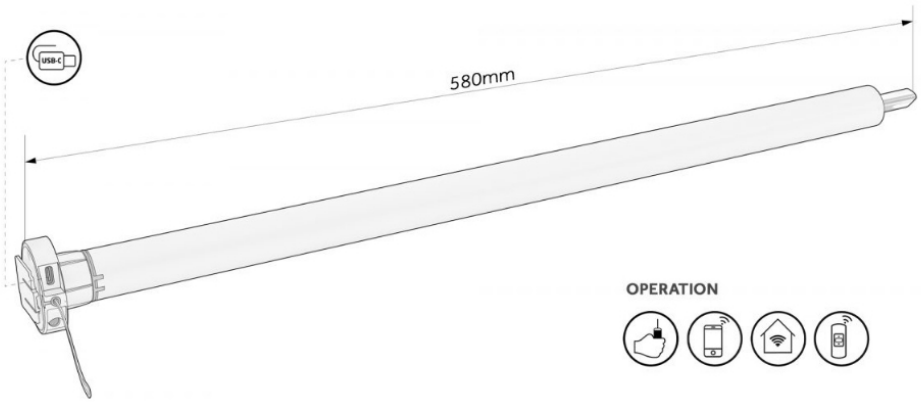

Motor specification

Motor diameter	Power source	Power input	Torque	Speed
25mm	Battery	USB-C 5V 12W - 1A	1.1NM	28RPM



3m USB-C Cable

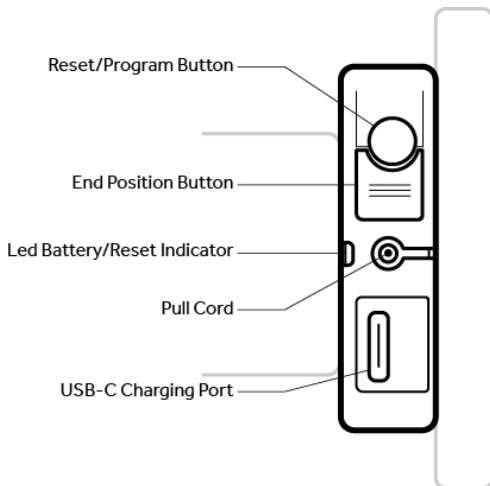

Accessories

Eve MotionBlinds are available with a selection accessories such as brackets, pulls and motor covers that come in plastic or metal and corresponding colours for that cohesive and stylish finish.

Brackets

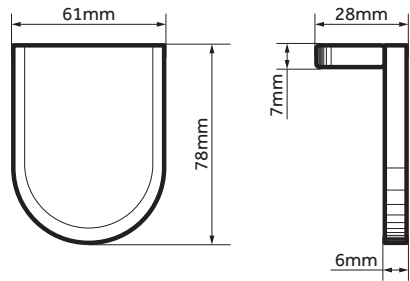
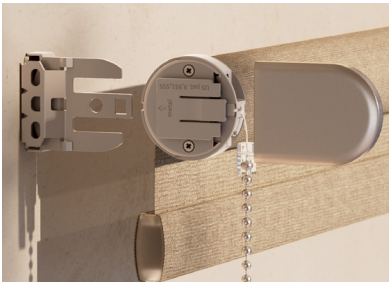

Brackets with plastic cover

Available in: WHITE, BLACK, ANTHRACITE, GREY

Brackets with metal cover

Available in: WHITE, BLACK NICKEL, STAINLESS STEEL, CHROME

Pull



Plastic Pull

Available in: WHITE, BLACK, ANTHRACITE, GREY

Metal Pull

Available in: WHITE, BLACK NICKEL, STAINLESS STEEL, CHROME

Pull Chain



Plastic Pull Chain

Available in: WHITE

Metal Pull Chain

Available in: BLACK NICKEL, GREY NICKEL, CHROME

Motor Cover



Plastic Motor Cover

Available in: WHITE, BLACK, ANTHRACITE, GREY

Metal Motor Cover

Available in: BLACK NICKEL, STAINLESS STEEL, CHROME

Capital Fascia

As practical as it is stylish, the Capital Fascia's modular design allows you to construct fascias that meet almost any dimension whilst still providing a sleek and modern finish for your Rollers



120 Capital Fascia

Available in: WHITE, BLACK, ANTHRACITE, CREAM, BRUSHED SILVER, CHAMPAGNE

90 Capital Fascia

Available in: WHITE, BLACK, ANTHRACITE, BRUSHED SILVER

Control

App, smart home, pull and remote

App Control

Eve MotionBlinds can be set up and programmed in a minute using Eve or HomeKit apps on an iPhone or iPad, drastically simplifying installation and control of motorised blinds.

Using apps also allows you control your blinds from anywhere in the world. This options requires a HomePod or Apple TV (4th generation or later) as home hub.

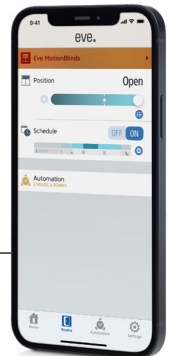
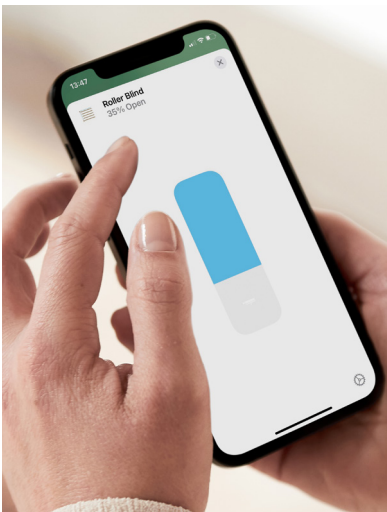

Smart Home Connectivity



Eve MotionBlinds provide outstanding ease of use and advanced security. Once connected, window coverings powered by Eve MotionBlinds interact with other HomeKit-enabled accessories that are part of your ecosystem, such as light bulbs, thermostats, smart speakers, etc.

Pull Control



On top of all smart controls, the manual pull operation is a valuable add-on since it always works and requires nothing: no connectivity, no smartphone, nothing. A short pull on the operating chain, cord or wand activates the motor and automatically sets your window coverings in motion. Anyone can do it.

Hand-held 15 Channel Remote



Setup & Programming Instructions

Written Instructions - PDF

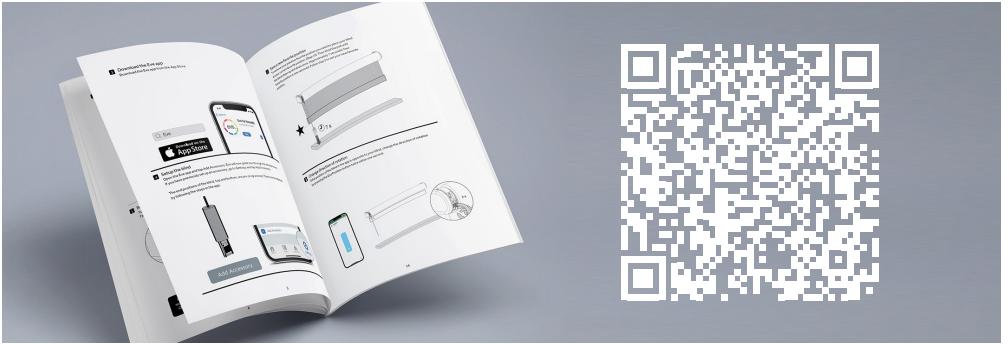

Video Instructions - YouTube

